



# KRAMPE HAREX®

## KNOW WHY.

### Data Sheet | Fibres

VERSION 06/2026

# SEGMENT WIRE FIBRE CORRUGATED STEEL FIBRES

1 Type of fibre    3 Length

**S W 50**

2 Shape of fibre



#### GEOMETRY

1 Type of fibre	Steel fibres from segment wire
2 Shape of fibre	corrugated steel fibres
3 Length	50 mm ± 10 %
d Diameter	2.3 - 2.95 mm ± 10 %
Thickness	0.45 - 1.00 mm ± 10 %
Cross section	round

#### MATERIAL PROPERTIES

Material	steel
Material number	1.0304
Tensile strength	> 800 N/mm <sup>2</sup>
Modulus of elasticity	210.000 N/mm <sup>2</sup>

#### CERTIFICATIONS & SYSTEM APPROVALS

Standards	DIN EN 14889-1
Certifications (DIN)	EN ISO 50001, EN ISO 9001:2015



#### DOSING DEVICES

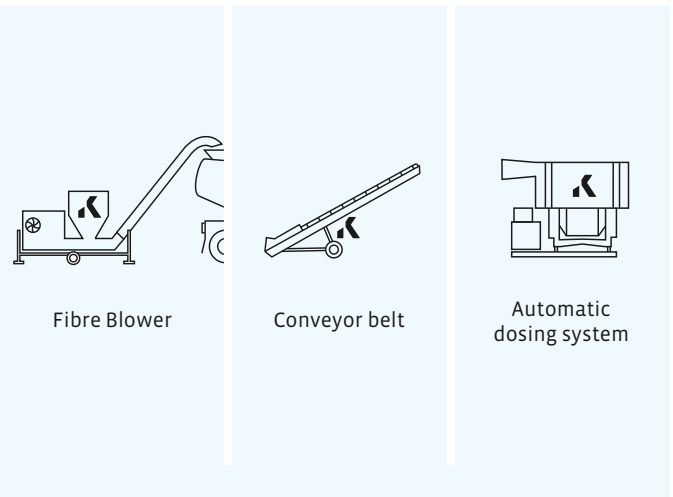

#### SERVICE+

We offer advice and recommendations on the right fibre, help with the configuration and selection of a suitable dosing device.

You can also find more information at: [krampeharex.com](http://krampeharex.com)

Subject to change without notice. All specifications are only a general description of our products.

#### INFO

Application examples  
> Industrial floors

#### SAFETY



Protective glasses



Gloves

#### PACKAGING (Standard)



Bags

20 kg Bag  
1200 kg Palett



Boxes

20 kg Box  
1000 kg Palett

#### STORAGE



Keep Dry